



T h e F e r r y N e w s

The **North Queensferry Gala is back for 2019** and we hope as many people as possible will join in the Gala week activities – there's something for everyone!

This year the week will run from Sunday 9th of June to Saturday 15th June - there will be the usual events culminating in an activity packed Gala day on the 15th. The Gala evening will be for over 18s and Sid's Garage will be performing again due to popular demand. Tickets are available at Wrights & Rankins.

The theme for this year's Gala has been chosen by Primary Seven – so start planning your rafts, house decoration and costumes – its Disney vs Marvel!

Will the Avengers sweep the board at the race or will it be more like Disney on Ice?? Make sure you come down to cheer them on and start planning your grand sandcastle designs now.

We can't guarantee the weather but fingers crossed June's weather will be good for the Gala Week activities:

- Sunday 9th June (2.30pm):** Beach Party/Sandcastle Competition & the Raft Race (Disney vs Marvel) – Port Laing Beach
- Wednesday 12th June (6.30pm):** Children's Running & Cycling Races – Community Centre
(7.00pm): Adult's Bridge Race – Community Centre
- Thursday 13th June (6.30pm):** Football & Netball – Community Centre
- Friday 14th June (6.30pm):** Scavenger – Treasure Hunt - Community Centre
- Saturday 15th June (noon):** Gala Procession – Town Pier

On Gala Day the procession of the King and Queen will start at the pier at 12 noon, followed by the Disney vs Marvel procession up the Brae and along Brock Street to the community centre playing fields. Be sure to come out and wave or join in! There's a prize for the best Disney vs Marvel decorated house.

We've got some fab activities planned for young and not so young – so come along and enjoy! The fabulous tea ladies will be offering a tempting array of cakes and biscuits – and tea funnily enough (contributions much appreciated). There will be other refreshments available and the children's lunch bags, have been kindly donated this year by The Doubletree Hilton at Queensferry Crossing.

Wrist bands will be distributed to children in the village, via the Primary School and nursery – which will give them a lunch bag and access to all the inflatables and entertainment at the Gala Day. If you would like to buy any additional vouchers for children attending, who don't live in the village – please contact us via the email address at the end of the article.

If anyone has any trophies or shields hidden somewhere in their house or shed – please let us know.

The North Queensferry Gala has been an integral part of community for many years – stretching back to the 1950s and last year we unfortunately didn't have the support to run it. This is a great Village tradition that needs the Village's support to keep it going, through local fundraising activities and the support of volunteers. Thanks again to all the Friends of the Gala who have offered support – we'll be in touch and if anyone else can offer any assistance during the week then please get in touch through the email below.

We hope you all enjoy the Gala week activities and we can make the 2019 Gala - the best one yet!!

Get in touch at northqueensferrygala@hotmail.com

Community Trust

We thought it would be useful to give you a brief summary of what has been happening through the Community Trust.

We have had a few new directors join the Community Trust recently which is very helpful (David Neil, Jim George, Freda Allan, Vanessa McCorquodale).

There are a few things on the go at the West Bay Marina :

- 1) The installation of public toilets / meeting space is progressing, although not as quickly as we might wish and is expected to be in a couple of stages with a temporary installation (which would have all the final ground works, sewage pumping, power etc), with a much later second phase of a new multi-purpose permanent building.
- 2) It is proposed that there will be storage containers, and a storage container workshop, in the yard area where the entrance to the railway tunnel was – these will be available for hire.
- 3) The Defibrillator has now been installed near the existing workshop
- 4) The harbour volunteers have also been refurbishing the benches and will be installing a new one
- 5) The repair of the holes in the sea wall by the workshop is proving problematic but is still something we are working to get repaired

The playpark at the Town Pier is covered separately in the newsletter but the Community Trust was the umbrella that existed to help this project on its way.

We are always keen to hear of new projects or suggestions that the Community Trust can support.

Thanks, and there is always information on the web page <http://www.nqcommunitytrust.org.uk/>

Patient Participation Group (PPG) (Inverkeithing Medical Group)

Do you suffer from a muscle or joint problem?

The NHS provides self referral help for those suffering muscle or joint problems. You can obtain advice and selfcare information by.....

- **Phoning** the Musculoskeletal (MSK) Advice and Triage Service on 0800 917 9390. The lines are open Monday to Friday 9am till 5pm. You can speak to trained advisors who will direct you to key advice to help you. (You must be over 16 to use this service)
- **Visiting** www.nhsinform.scot/msk
- **Downloading** the “MSK Help” app free from the app stores

If you have comments or suggestions for the PPG group, please contact us by leaving a note in the suggestions box at the surgery or emailing on fife-uhb.img@nhs.net. (Please do not use this email for medical matters.)



Following the success of our Easter “Messy Church”, we intend to hold a BBQ with games and crafts on Sunday 25 August at 4pm at North Queensferry Church. Bring a grown-up (Dads especially to help with games and BBQ !!!)

**Your Community Council meets
in the Community Centre at
7.30pm on the second Thursday
of each month
Everyone is welcome**

**Contributions for the next issue
are to be with us by
Friday 4th October 2019
E: mary@ferrynews.org.uk**

Community Council

Defibrillators will be operational soon at Battery Road Bus Stop, West Bay Marina and later, at the Community Centre. Some training is due to be organised.

The Edinburgh Airport Flight Path Consultation is about to recommence and we will be closely involved with this to minimise the impact of new flight paths on our Community.

Traffic issues continue at Pierhead with some anti social behaviour by drivers and arbitrary abandonment of vehicles... Efforts are being made to improve signage to direct visitors cars to the Battery Road car park. A Residents Only Zone is costly to implement and difficult to enforce. On Brock Street, measures are proposed to improve parking, two of our Ward Councillors will consult on this.

The Setts at the War Memorial and on Main Street are due to be repaired in September – this will require a temporary road closure.

We understand that Fife Council has money to reinstate a public toilet at Battery Road but now the running costs have to be found. We are keeping up pressure on this issue, given the number of visitors to the village.

The Albert Hotel is at present blight on the village and efforts are being made to contact the leaseholder and the owner to improve the appearance of the building – and encourage reopening.

Village Show

The Village show will be taking place on Saturday 7th September with the usual range of classes including produce, home crafts, floral art, photography and baking. This year you are invited to make Twiddle Muffs and/or Peace Pals which can be donated to various charities. Patterns for these can be found online at www.pinterest.co.uk and www.knitting4peace.org. Exhibits can be delivered to the Community Centre on Friday 6th between 7.00 and 8.00pm and on the Saturday morning between 9.00 and 10.30am.

The show will open to the public at 2.00pm and there will be the usual sales tables, competitions, raffle, auction and much, much more. It will culminate with the Prize Giving at 3.20 followed by the auction at 3.30 and finishing with the raffle.

Admission: £1 child - £2 adult - £4 family

We recently investigated the issue of ticks and established that deer are not to blame for the presence of ticks. Warmer weather conditions has increased numbers. There are no natural predators and anything on legs – moves them around. Be careful to remove any ticks: <https://www.nhs.uk/conditions/insect-bites-and-stings/treatment/> using a tick removal tool – available at the pharmacy. Lyme disease is not present in this area but be aware of the symptoms: <https://www.nhs.uk/conditions/lyme-disease/>

Beach cleaning goes on throughout the year. With corporate groups eg, Amey and campaign groups such as Marine Conservation Society and FIDRA we are able to involve a larger number of volunteers. But there is an ongoing effort by individuals from within and outwith the village. If you require bags or litter pickers please contact us.

The planting on The Brae and various planters are maintained by our small Floral Enhancement Team. If you can help please contact. The slope above the well is due to be landscaped by Fife Council.

Community Council meetings are at 1930 Thursdays 13 June / 11 July / 12 September North Queensferry Community Centre. All Welcome

Pilates Classes



8 week block booking £72. Booked in advance.

Suitable for all fitness levels. Small class numbers.

Class Timetable

Monday	6.30-7.30pm	SQ_Rosebery Main Hall
Monday	7.40-8.40pm	SQ_Rosebery Main Hall
Tuesday	10.30-11.30am	SQ_Rosebery Small Hall
Tuesday	12.45-1.45pm	Davidsons Mains Parish Church
Wednesday	10.00-11.00am	Davidsons Mains Parish Church
Wednesday	12.00-1.00pm	SQ_Rosebery Small Hall
Thursday	9.55-10.55am	Dalgety Parish Church
Thursday	11.05am-12.05pm	Dalgety Parish Church

Contact: Amanda Johnstone

10 years Qualified & Experienced Mat Level 3 Instructor

Tel: 07787 321571

Email: amanda@simplypilates.org

Web: www.simplypilates.org

Our Cambodia Trip – Can You Help?

We are four Inverkeithing High Schools pupils from North Queensferry who have signed up to a four-week trip to Cambodia in early Summer 2020. This is to be organised by a not-for-profit organisation which specialises in such trips. It is centred on voluntary work in a local community under the leadership of local workers, trekking in the jungle and immersion in the Cambodian culture. The projects are intended to deliver transformative change in those local settings – help with local education, housing, healthcare and sanitation, food and water initiatives or environmental protection. We will be working with students from elsewhere in the UK and further afield. It really is a once in a lifetime opportunity.

Part of the challenge is to fundraise a significant sum of money to help cover the cost of the trip, without which we won't be able to go. We will all be working hard over the coming months on that fundraising, and some of that will be locally here in North Queensferry. We would really appreciate your support. If you want to get in touch to find out more or to offer any help, we'd love to hear from you. In the

first instance you can contact us at elijahmcgregor7@gmail.com, or speak to any one of us individually.

We will likely do some of our fundraising together but also as individuals, or in twos and threes. As a first fundraiser, Louis is offering to cook a two-course meal in the homes of North Queensferry residents in exchange for a donation. His dad Martin will come along as his sous-chef and kitchen porter. Louis has boundless gastronomic enthusiasm and extensive cooking experience not least from his part-time job in The Wee Restaurant. If you are interested in your own private chef experience, please contact Louis at lfjudd2004@gmail.com.

His mum Ali used to supply cakes to Rankin's and is also baking cakes and making tablet for the cause. If you would like to commission cake Ali can be contacted at alijudd@tiscali.co.uk.

Thank you in anticipation of your support!

Beth Lindsay, Ellie McGregor, Hannah Taylor and Louis Judd

VILLAGE COFFEE MORNING



**IN NORTH QUEENSFERRY CHURCH
ON ALTERNATE WEDNESDAYS**

10:30 TO 12 NOON

ALL AGES WELCOME

2019 Dates as follows:

June	5	19	
July	3	17	31
August	14	28	
September	11	25	
October	9	23	
November	6	20	
December	4	18	

Mobile Library

The Mobile Library van visits every other Monday at Whinneyknowe (12.25-12.55) and Inchcolm Drive (14.10-14.40). The next dates in 2019 are May 13th and 27th; June 10th and 24th; July 8th and 22nd; August 5th and 19th; September 2nd, 16th and 30th; October 14th and 28th.

The Mobile Library carries a good selection of books, including books for children. As well as borrowing books, you can reserve books and collect them from the van later. The staff are very helpful and you can even join the library there - take your MyFife card or other ID.

The more we use our Mobile Library, the greater our chances of keeping the service.

Jog Scotland North Queensferry

We meet every **Friday morning at 09.15**.

Sessions suitable for beginners but all levels can be catered for.

Meeting point North Queensferry Railway Station.

For further details find us on Facebook.

Ferry Birds

January to May 2019

West Bay has been the focus for many of our resident and wintering birds. At least 12 **shelducks** spent the winter there and there were still 2 there at the beginning of May. The usual flock of **redshanks** spent the winter with us. They have nearly all left to go to their breeding areas in Iceland and Northern Scotland. There were about 50 during the winter but I saw just one on the floating mooring in West Bay on the 8th of May. Other waders in the Bay have been up to 4 **curlews** and several **oystercatchers**. The **curlews** leave to breed on moorland while some of the **oystercatchers** stay here to breed. Several **aiders** have appeared and in a few weeks we can expect to see small balls of feathers on the water frantically trying to keep up with mum!

As happened last year the numbers of ducks and grebes spending the winter around the coast have been quite low. In previous years I could guarantee to see **little grebes** on the sea from the coastal path to Inverkeithing. This year I saw very few. However I saw them throughout the winter on Kinghorn Loch so they are still around and maybe changing their routine to suit the weather we have been having. Other birds I have seen occasionally from the coastal path or in Inverkeithing Inner Bay have included **shelducks**, **mute swans**, **goldeneyes**, **aiders** and a small flock of **red-breasted mergansers** on the 24th of March.

The first sign of breeding activity amongst the sea birds was, of course, the **fulmars** on Inchgarvie. I saw them first on the 19th of January but they had disappeared by the next day. This coming and going carried on 'til early February and now there are always some on the island and up to 4 pairs on the quarry face above Deep Sea World.

The first summer visitor to be heard and seen was a **chiffchaff**. This year my first was heard from the coastal path between Kinghorn

and Kirkcaldy on the 21st of March and they soon became common around North Queensferry. The **blackcaps** arrived later, only becoming common by the middle of April. The other common warbler is the **willow warbler** and the north end of the village is a favoured spot to hear one.

The noisiest summer visitors have just arrived. **Common terns** were first seen flying around West Bay on the 6th of May and several were perched on the first dolphin on the 10th. I hope they have a better breeding season this year.

Other interesting sightings have included a **peregrine falcon** on the cliffs at Cruickness quarry on the 1st of May and a **raven** in the same place at the end of April. **Yellowhammers** have been singing from the bushes in the water tank field and one was on Carlingnose reserve at the beginning of May. If you get a good view of one you can appreciate how the yellow of their heads make them very difficult to see when they perch on a gorse bush in full flower. Any predator will have great difficulty working out what's edible amongst the yellow flowers.

A summer visitor to the quarry is the **sand martin**. This bird builds nests in the waste material in the quarry. It digs into this creating a short tunnel with nest at the end. Several were flying around last year's nesting site on the 29th of April.

As usual a plea to leave some of your garden unmanaged so that the insects and other invertebrates on which many of our birds depend can thrive.

John Done

Summer Nature Walk with John Done...

The summer Nature Walk will happen on Saturday the 19th June.

As usual the walk will start at 10:30 from the War Memorial. We expect there will be a lot to talk about with the full gathering of birds (hopefully) on show.



FREE Consultation

On any property issue

Call today 01383 417 509

adrian@1st-architects.com 1st-architects.com

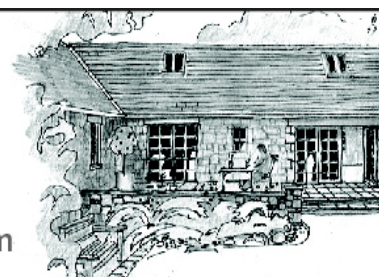

Local relationship banking

At Handelsbanken relationship banking still lives up to its name. You only ever deal with people you know by name and decisions are made locally by us at the branch. Our simple aim is to provide the best possible service to our customers.

Jim Donnelly - Branch Manager

Tel: 01383 726067, Email: jado02@handelsbanken.co.uk

Handelsbanken

handelsbanken.co.uk/dunfermline

Handelsbanken is the trading name of Svenska Handelsbanken AB (publ). Registered Office: Svenska Handelsbanken AB (publ), 3 Thomas More Square, London, E1W 1WY. Registered in England and Wales No, BR 000589. Incorporated in Sweden with limited liability. Registered in Sweden No, 502007-7862. Head Office in Stockholm. Authorised by the Swedish Financial Supervisory Authority (Finansinspektionen) and the Prudential Regulation Authority and subject to limited regulation by the Financial Conduct Authority and Prudential Regulation Authority. Details about the extent of our authorisation and regulation by the Prudential Regulation Authority, and regulation by the Financial Conduct Authority are available from us on request.

NEW PUBLICATION

Society of Antiquaries
of Scotland

The Fortification of the Firth of Forth, 1880-1977:

'The most powerful naval fortress in the British Empire'

BY GORDON J BARCLAY AND RON MORRIS

Published March 2019

Hardback | 23.8 x 30 cm
ISBN 978-1-908332-14-1
272 pages | more than 220 illus.

The Fortification of the Firth of Forth describes the story of the great Forth Fortress from 1880 to 1977, when the final traditional defensive capabilities were abandoned. Meticulously researched, the authors combine archival sources with new fieldwork and oral histories to not only describe what was built, but when and why. The authors also examine how the defences were expected to be used, in rapidly changing strategic circumstances and in the face of increasingly complex and powerful naval weapons.

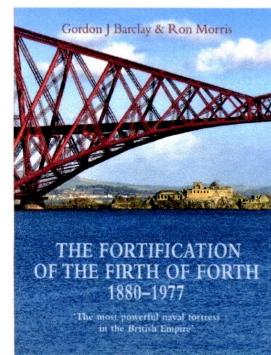

This richly illustrated volume relates the defences in the Forth to the wider political and military context and also describes the human side of the defences: the men and women who manned the fortress. This is a fascinating resource for those interested in Scottish military and naval history, as well as conflict and battle archaeology.

£5 DISCOUNT

This book is available for purchase now. This flyer entitles the bearer to a £5 discount on the RRP. Simply enter 18801977FF at the checkout. This offer is valid until 1 November 2019

www.socantscot.org/shop

Society of Antiquaries of Scotland

National Museums Scotland, Chambers Street, Edinburgh EH1 1JF

Web: www.socantscot.org | Tel: 0131 247 4214 | Email: sales@socantscot.org



The current exhibition at the station is 'Famous Artists in North Queensferry'. The "famous" artists include Charles Martin Hardie (a former resident of North Queensferry), JW Turner and Terence Cuneo. They all painted iconic pictures that will be recognised by all. See the new poster that is currently on display at the station.

The "Famous Artists" exhibition is also open to local artists so if you, or someone you know, would like to display their work please get in touch via our email NQHTinfo@gmail.com. Any artwork displayed will be located in the main meeting room which will only be open when there is a volunteer available. If you wish to sell any artwork or craft then NQHT (a charity) would expect a donation to help with the up-keep of the station.

Famous Artists in North Queensferry

The artists that helped to define Scotland!

North Queensferry Heritage Trust welcomes you to this exhibition dedicated to the world famous artistic talents of JWM Turner, Charles Martin Hardie - RSA, a former resident of North Queensferry, Martin Hardie, Terence Cuneo and Sir John Lavery... supported by local artists of today.

We are grateful to The Royal Collection Trust, National galleries of Scotland, Abbotsford Trust, Cuneo Estate, Imperial War Museum, Science & Society Picture Library, Fine Arts Museum of San Francisco, Trustees of the Tate, Rijksmuseum Amsterdam, Irvine Burns Club, The Royal Caledonian Curling Club & our local anonymous donor.



All sketches and paintings on display are copies of the originals which the Trust gratefully acknowledges their contribution to the exhibition.



Forth Bridge Heritage Centre
April - September 2019

The original artist's palette of CM Hardie has been loaned from the Royal Scottish Academy for which we are also grateful.

NQ Primary School Council is made up of a small group of parents. We are proud of our fantastic little school and all of the brilliant learning opportunities the school brings to the children and our village. As a group, our aim is :

- a) to promote close co-operation and communication between parents and teachers
- b) to promote equality and fairness
- c) to study and discuss matters of mutual interest relating to the education and welfare of pupils
- d) to engage in activities which support and advance the education of pupils attending the school

Most recently we've been supporting pupils from the nursery who have had places at the school declined. At time of going to press, this has the effect of the school classes being reduced to 3. We are busy working with local councillors, MSPs and Fife Council to explore how we can work together to support measures to grow the school and resist this decline in class numbers. We are also busy trying to improve the school garden, planning a science fair and fundraising events. Please let us know you can help us to support our lovely school and help continue it being a central part of NQ life by getting involved in the school council.

Sarah, Ali, Nigel and Erica

nqparentcouncil@gmail.com

Ps - please follow the school on twitter to find out what brilliant opportunities our tiny school gives to its pupils! If you live in the village and don't currently send your child to NQ school but would like information about doing so, don't hesitate to contact us or the school directly.

68th Fife Scout Group

(Inverkeithing)

New Members Welcome

Come along for a trial visit

Beavers (6 to 8 years): Tuesdays 6.15-7.30pm

Cubs (8 to 10 years):Thursdays 6.30-8.00pm

Scouts (11 to 14 years): Mondays 6.30-8.30pm

Explorer: Monday's 8.30-10.00pm

BP Hall, Hope Street, Inverkeithing

Please email kevinlloyd6@msn.com with any enquiries

Pierhead Play Park

The Tender process is now complete and at a pre-award meeting back in March 2019, the contract was awarded to Hawthorn Heights to re-furbish the play park.

The procurement of the specialist and inclusive equipment is progressing, however there is a lengthy lead time on this and with the contractors commitments to other projects, it's unlikely that an effective start on site would be before August of this year.

On reflection, the Support Group have requested that the contractor makes due allowance for their summer closedown prior to the commencement of the works. This should avoid any interruption to the site work. Taking all these factors into account the start date looks like being nearer the end of August / beginning of September 2019.

Assuming there are no major issues, the works should be complete within 6 weeks.

We have received confirmation that the contractors welfare facilities will be housed within the Battery Road Car Park, and this should minimise traffic at the Pierhead.

We intend to keep you updated, and certainly the residents local to the park will receive information, possibly in the way of flyers, on start dates, progress etc.

We are encouraged by the response from local business as we continue to build up our funds for the project.

Our web site is:

www.pierheadplayparkproject.org.uk

Ferry Property Maintenance Services

Building work and all types of maintenance

Building: concrete block, brick, stone, paving, slab, underground drainage, channel drainage, landscaping.

Roofing: slate, tile, zinc, felt, lead work, flat roof.

Guttering: cast iron, plastic, aluminium.

Roughcasting: dry, wet, lime.

Plaster boarding: wall, ceiling, plastering.

Woodwork: fencing, decking and more

Repair or new, no job too small.

*Fully registered and insured business
I provide a maintenance service inside, outside and garden
Fixed rate, no VAT to be added, ask for free estimate.*

For work requiring specialised trades, I bring in recommended experienced tradesmen such as joiner, plumber, electrician, blacksmith, tiler.

Oliver James: Builder

Mobile Phone: 07815029249

Email: ferrypropertymaintenanceservices@outlook.com





Sunrooms

Extensions

Conservatories

Windows

Entrance Doors

Aluminium Bifold Doors

Timber Sash & Case

Velux Roof Windows

Temperature Control Units



Come and see our range at
Macintosh House, Innova Campus,
Viking Way, Rosyth, Fife KY11 2UU

**SHOWROOM
OPEN
7 DAYS
A WEEK**



CALL 01383 851951
EMAIL hello@srjwindows.com
VISIT www.srjwindows.com

srjwindows
conservatories. sunrooms. windows. doors.